

## Trimapanel® Flat FW

Insulated secret fix, smooth faced architectural wall panel system

Trimapanel® Flat FW from Building Systems UK provides an external aesthetic to your building facade providing an efficient highly insulated envelope solution with superb weatherability and air tightness with enhanced fire resistance.

Manufactured in factory conditions operating to quality management standard BS EN ISO 9001:2015, environmental management standard BS EN ISO 14001: 2015 and occupational health and safety management standard BS EN ISO 45001:2018.

Full traceability of all component materials and certified 'very good' to BRE's responsible sourcing standard BES 6001.

**Table 1 - Range (U-value & weight)**

Overall Thickness (mm)	90	120
U-value (W/m²K)	0.24	0.17
Weight (Kg/m²) *	12.67	13.85

\* Weight based on standard combination of steel skin gauge

**Table 2 - Dimensional scope**

Cover width (mm)	+2
Thickness (mm)	+2
Squareness (mm)	<6
Length (mm) < 3 m	-2 +5
Length (mm) > 3 m	+10
Maximum length (mm)	12000
Minimum length on-Line (mm)	2400
Minimum length off-Line (mm)	300

**Figure 1. Trimapanel® FW Flat cross section**

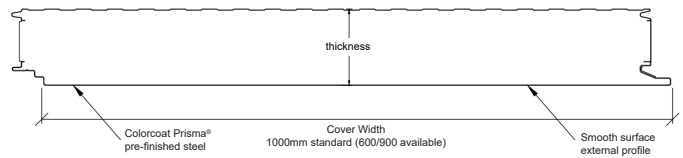

All measurements are mm unless stated

**Table 3 - Flatness**

For L = 200mm	0.6
For L = 400mm	1.0
For L > 700mm	1.5

(L = length of measurement between high points)  
Tolerances are in accordance with BS EN 14509

**Table 4 - Accessories and finishes**

Accessories	Base Clip, Vertical Top Hat Joint, Formed Corners, Fasteners
External finishes	Colorcoat® HPS200 Ultra
Standard internal finish	Colorcoat® PE15
Available internal finishes	Colorcoat® High Reflect, Colorcoat® HPS200 Ultra, Colorcoat Prisma®, Advantica® L Control

## Platinum® Plus 25 year system guarantee.

Trimapanel® Flat FW and a range of system components including fixings, wall lights, sealants and fillers are available with our Platinum® Plus system guarantee providing a complete building envelope solution guarantee for 25 years.

Colorcoat® HPS200 Ultra pre-finished steel is used as standard, offering long-term performance with the Confidex® Guarantee and providing peace of mind for up to 40 years. [Click here to learn more](#)



Our online specification generator tool has been designed to help you create the right specification to suit the needs of your project, making sure all roofing and cladding components listed are compatible and perform as a guaranteed system.



[Click here to build your specification](#)

# Product performance

**Table 5 - Resistance to fire (non-load bearing wall)**

Product	Panel thickness (mm)	Orientation	Test standard	Insulation (mins)	EN 1364-1 Integrity (mins)		Tested Span (mm)
					Sustained flaming penetration	Gap gauge	
Trimapanel® Flat FW	90	Vertical	EN 1364-1	24	120	120	3000
Trimapanel® Flat FW	90	Horizontal	EN 1364-1	19	104	132	3000
Trimapanel® Flat FW	120	Vertical	EN 1364-1	24	120	120	3000
Trimapanel® Flat FW	120	Horizontal	EN 1364-1	19	104	132	3000

See Figure 2 for joint configuration.

## Reaction to fire

- Trimapanel® Flat FW panels are classified B-s2,d0 according to the European Reaction to Fire classification system (Euroclasses) BS EN 13501-1: 2018 when tested on the standard internal face of the product.

## Third party accreditations

- LPCB (Loss Prevention Certification Board) approval to LPS 1181 Part 1.2 certified to EXT-B for all thicknesses.
- Approved to FM Class 4880, 4881 and 4471 to an unlimited wall height.
- Specification is critical for compliance. Our Technical Team can help you with your specification drafting - or you can use our [SPECGEN tool](#).



## Weatherability

- In accordance with product standard BS EN 14509, the watertightness of a system should be tested to BS EN 12865. The standard advises that the system should achieve watertightness to a pressure of 600 Pa for normal conditions. Laboratory testing evidenced that the system is water-tight up to a pressure of 1050 Pa.

## Air-tightness

- In accordance with product standard BS EN 14509, the air tightness of a system should be tested to BS EN 12114. Laboratory tests evidenced that the system has an air leakage as low as 0.48 m³/h/m².



**Figure 2. Horizontal joint detail**

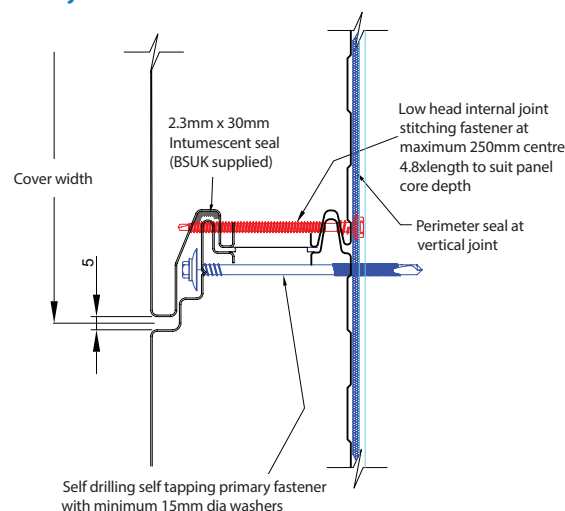

## Acoustic

- The sound reduction performance of the system has been predicted using software developed by Building Systems UK. The results below are based on a 120mm panel thickness.

**Table 6 - Sound reduction data**

Frequency (Hz)	SRI Values (dB)*	Frequency (Hz)	SRI Values (dB)*
100	12.5	800	27.7
125	14	1000	29.4
160	15.7	1250	31.1
200	17.3	1600	23.6
250	19	2000	34.8
315	20.7	2500	35.8
400	22.4	3150	34.6
500	24.1	4000	32.2
630	25.9	5000	31.7

Weighted S.R.I RW = 29.0 dB

\* The predicted sound reduction index values should only be used to provide guidance for preliminary design and/or appraisal of cladding systems. For information on other thicknesses or test evidence please contact the Building Systems UK Technical Department, email: [technical.envelopeproducts@tatasteelurope.com](mailto:technical.envelopeproducts@tatasteelurope.com)

## Span tables

The span tables below have been created in accordance with BS EN 14509. For the use of wall cladding only. The values are based on a maximum permitted deflection of span/150. Fastener performance has been taken into account within these tables based on a 2mm thick steel purlin/rail and assuming 2 fasteners per support.

The panel is assumed to have a minimal land of 60mm at each support position. If the perimeters above do not suit the specification of your project please contact Building Systems UK Technical Department who will be happy to adjust these to suit and produce a new set of load span data. Email: [technical.envelopeproducts@tatasteeleurope.com](mailto:technical.envelopeproducts@tatasteeleurope.com)

**Table 7 - Trimapanel® Flat FW 90 span table**

Load Case	Span Condition	Span (mm)										
		1500	1750	2000	2250	2500	2750	3000	3250	3500	3750	4000
Safe imposed loading (kN/m <sup>2</sup> )	Single	6.55	5.61	4.91	4.22	3.57	3.05	2.62	2.27	1.97	1.72	1.51
	Double	5.11	4.38	3.83	3.41	3.07	2.79	2.55	2.36	2.19	1.98	1.67
	Multi	5.11	4.38	3.83	3.41	3.07	2.79	2.55	2.36	2.19	2.04	1.84
Safe wind suction loading (kN/m <sup>2</sup> )	Single	-5.62	-4.82	-4.22	-3.73	-3.02	-2.50	-2.10	-1.79	-1.54	-1.34	-1.18
	Double	-2.81	-2.41	-2.11	-1.87	-1.69	-1.53	-1.41	-1.30	-1.20	-1.12	-1.05
	Multi	-2.81	-2.41	-2.11	-1.87	-1.69	-1.53	-1.41	-1.20	-1.20	-1.12	-1.05

**Table 8 - Trimapanel® Flat FW 120 span table**

Load Case	Span Condition	Span (mm)										
		1500	1750	2000	2250	2500	2750	3000	3250	3500	3750	4000
Safe imposed loading (kN/m <sup>2</sup> )	Single	8.26	7.08	6.20	5.51	4.96	4.44	3.86	3.38	2.96	2.61	2.31
	Double	5.35	4.58	4.01	3.56	3.21	2.92	2.67	2.47	2.29	2.14	2.00
	Multi	5.35	4.58	4.01	3.56	3.21	2.92	2.67	2.47	2.29	2.14	2.00
Safe wind suction loading (kN/m <sup>2</sup> )	Single	-5.62	-4.82	-4.22	-3.75	-3.37	-3.07	-2.79	-2.38	-2.05	-1.79	-1.57
	Double	-2.81	-2.41	-2.11	-1.87	-1.69	-1.53	-1.41	-1.30	-1.20	-1.12	-1.05
	Multi	-2.81	-2.41	-2.11	-1.88	-1.69	-1.53	-1.41	-1.30	-1.20	-1.12	-1.05

## Site Guidance

Guidance on delivery, offload and construction can be [found here](#). These recommendations should be considered together with our typical construction details (see useful links opposite).

## Packaging

The panels are stacked onto wooden pallets. The number of panels per pack will vary according to the length and depth of panel, typically panels are packed in stacks up to 1,100mm high.

Our pallets are sourced from an FSC certified supplier and are returnable for repair and recycling.

The panels are protected for transportation and storage by a baseboard and polymer shrink wrap. Local arrangements should be checked for recycling of these items.

## Maximum pack size

Maximum number of panels within a pack for varying panel lengths

Table 9 - Core thickness (mm)	Panel Length (m)	No. of Panels
90	<5	11
	5 - 7	8
	7 - 9	6
	9 - 12	5
120	<5	6
	5 - 7	8
	7 - 9	6
	9 - 12	5

## Watch our installation guides



## Other useful links and downloads



- Declarations of performance
- BES 6001 Certification
- LPCB fire approval certification
- FM Approval certificate
- Vertical wall CAD drawings
- Horizontal wall CAD drawings
- Request a CPD

# [www.buildingsystemsuk.com](http://www.buildingsystemsuk.com)

## **Trademarks of Tata Steel UK Limited**

Trimapanel®, Colorcoat®, Colorcoat Prisma®, Advantica® and Platinum® Plus are registered trademarks of Tata Steel UK Limited.

While care has been taken to ensure that the information contained in this publication is accurate, neither Tata Steel, nor its subsidiaries, accept responsibility or liability for errors or for information which is found to be misleading.

Before using products or services supplied or manufactured by Tata Steel and its subsidiaries, customers should satisfy themselves as to their suitability.

Copyright 2025

Tata Steel UK Limited

## **Building Systems UK (A Tata Steel Enterprise)**

Shotton Works

Deeside

Flintshire

CH5 2NH

United Kingdom

T: +44 (0) 1244 892199

E: [technical.envelopeproducts@tatasteeleurope.com](mailto:technical.envelopeproducts@tatasteeleurope.com)

Registered Office: 18 Grosvenor Place, London, SW1X 7HS, Registered in England No. 02280000

Doc No: BSUK-E-0016-02 [View UK](#)